

## Aluminium Profile - Down Only

### Product Description:

- Single profile solution with multiple slots to vary the distance between the front cover and the light engine.
- Magnetic end caps for seamless integration.
- Can be suspended or surface-mounted.
- Fully designed for the LEDiL Diana system, offering unique glare control and high output using patented microprismatic technology.
- Sold as a set in 4-foot (1200mm) lengths or as 2500mm long extrusions for custom sizing.
- Stocked in France in white or black, supplied with all necessary parts such as end caps, suspension kits, and mounting accessories.
- Matching drivers and PCBs available.

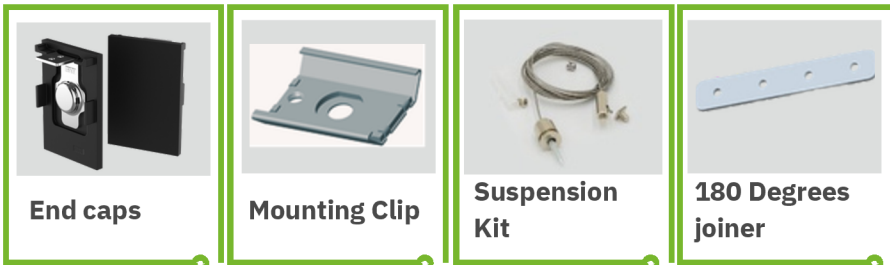

End caps

Mounting Clip

Suspension Kit

180 Degrees joiner

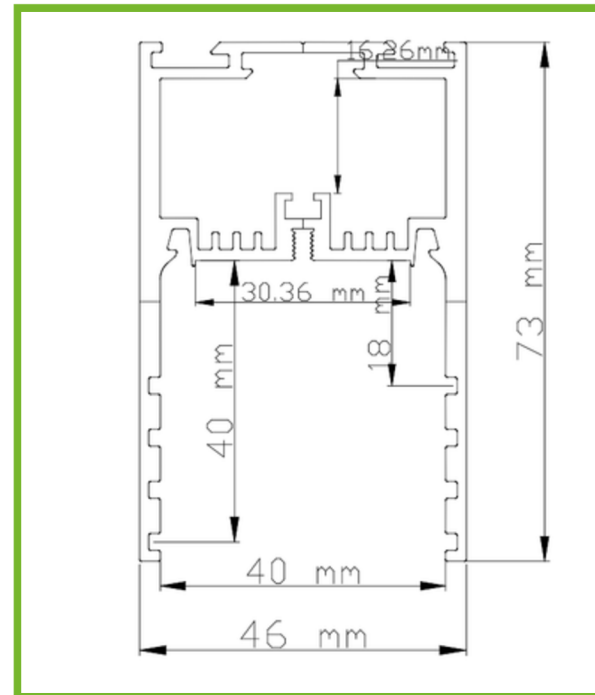

Dimensions

### LIST OF ARTICLES

- TP27-01 TP-27 Profile for Diana
- TP27-03 Pair of End Caps
- TP01-06 Surface Mounted / Suspension Clip
- TP01-09 Suspension Kit
- TP01-08 180 Joiner

### LEDiL DIANA Beams

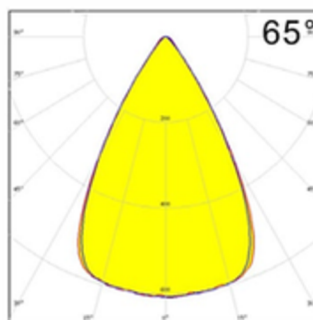

DIANA-40-W

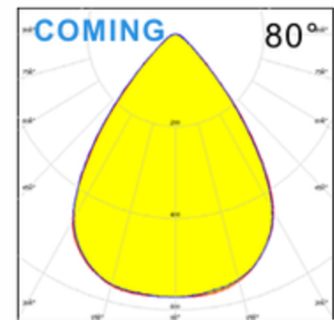

DIANA-40-WW

### LEDiL DIANA Parts:

