

Product Description

- different power range adjustable with DIP switch
- constant current LED driver
- output current: 900mA, 950mA, 1000mA and 1050mA
- max output power 40W
- lifetime up to 50000 hours
- insulation Class: I, II
- temperature protection comply with EN61347-2-13 CE
- 5 years warranty
- The Class II symbol is just considered by driver, not by adaptor system.
- Track adapters can be used with Class III luminaires.
- Suitable for following tracks
 - NA Globaltrac pro
 - Eutrac 25101
 - Stucchi
 - Ivela
 - Unipro
 - Concord
 - Hoffmeister
 - further on request

Flicker Free Concealed Adaptor with Integrated LED Driver (3 Phase)

SC40W900-1050CG-4

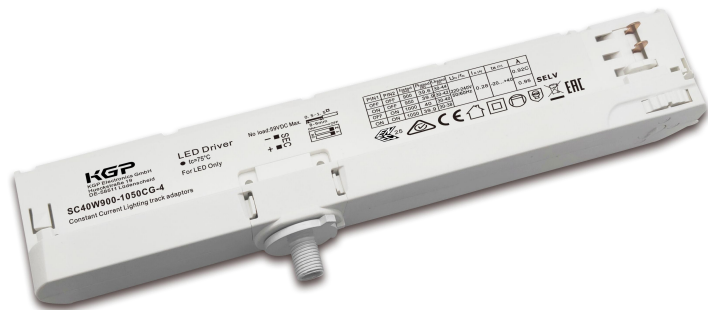

Performance

- Case: PC(polycarbonate), fire-protection rating: 91-V0 conformed with ROHS
- Color: black RAL9005 (B) ,grey RAL7040 (G) ,white RAL9016 (W)
- Nipple color: black RAL9005 (B) ,grey RAL7040 (G) ,white RAL9016 (W)
- Red copper alloy contacts
- 2KV surge
- ingress protection: IP20

Product Characteristics

- The lamp control gear does not rely upon the luminaire enclosure for protection against accidental contact with live parts, the LED light source load can't be accessible.
- If the components are unsuitable for the connection of inductive loads, or de-rating for inductive loads if appropriate.
- It is the user's responsibility to ensure electrical, mechanical and thermal compatibility between the track system and luminaires attached to it.
- for LED lamps use only

Protections:

- Over-load protection
- Short Circuit protection
- No-load protection
- Under-voltage protection

Specifications

| | |
|--|--|
| Rated supply voltage | 220-240V |
| Input voltage | 198-264VAC or 200-250VDC |
| Mains frequency | 50-60Hz |
| THD (at 230 V, 50 Hz, full load) | < 20 % |
| Output current tolerance | ±5% |
| Output current ripple (at 230 V, 50 Hz, full loaded) | ±5%(I _{max} -I _{min})/(I _{max} +I _{min}) |
| Inrush Current | 35A/2.8µs |
| Connected quantity of 16A Breaker | 22pcs/type B ; 35pcs/type C @230Vac |
| Surge withstand resistance | L-N/2KV |
| Insulation and voltage resistance | 3.0KV/60s/5mA |
| Starting time (at 230 V, 50 Hz, full loaded) | <0.5 s |
| Turn-off time (at 230 V, 50 Hz, full loaded) | <0.3 s |
| Ambient Temp (ta): | -20...+40°C |
| The maximum permissible track temperature under normal operating conditions: | 40°C |
| Life time | 70000 hours@35°C 50000 hours@40°C |
| Storage Temp: (ts): | -30...+75°C |
| Size L×W×H | 250 x 31 x 45 |
| Net weight: | 155g |

Product size:

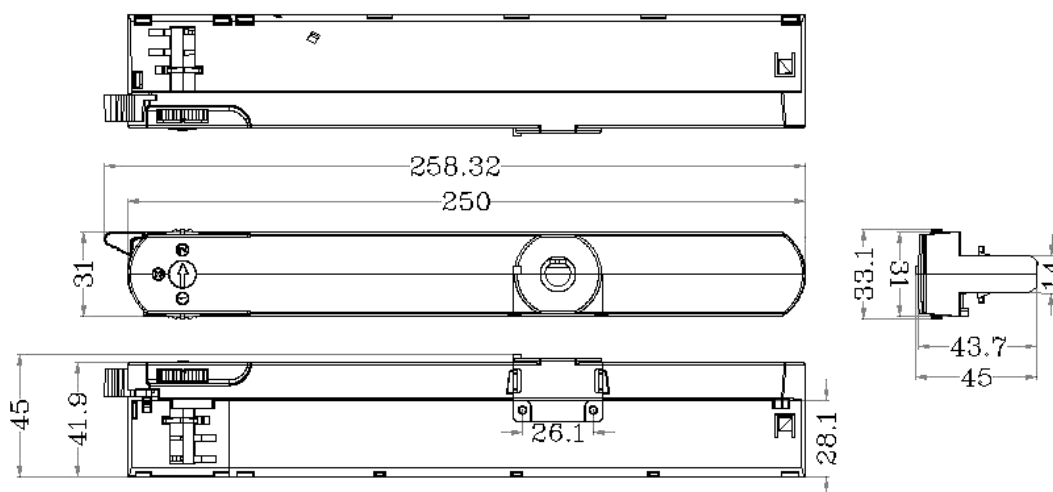

Standards:

| | | | | | |
|----------|----------------------------|------|-------------------------------|------|---------------------------|
| ENEC+CE: | EN 55015: 2013/A1: 2015 | CB : | IEC 60570:2003 | SAA: | AS/NZS IEC61347.2.13.2013 |
| | EN 61000-3-2: 2014 | | IEC 60598-1:2014 | | AS/NZS 61347.1.2016 |
| | EN 61000-3-3: 2013 | | IEC 61347-1:2015 | | AS/NZS 60598.1:2017 |
| | EN 61347-1:2015 | | IEC 61347-2-13:2014 | | |
| | EN 61347-2-13:2014/A1:2017 | | IEC 61347-2-13:2014/AMD1:2016 | | |
| | EN 61547:2009 | | | | |
| | EN 62384:2006/A1:2009 | | | | |
| | EN 60598-1:2015 | | | | |
| | EN 60570:2003 | | | | |

Glow-wire test

According to EN61347-1, pass 850°C temperature test.

Over-load protection

If the output voltage range exceeded rated range, the LED Driver reduces the LED output current or in burst modes. After elimination of the overload the nominal operation is restored automatically.

Short circuit protection

In case of a short circuit on the secondary side (LED) the LED Driver switched off. After elimination of the short-circuit fault the LED Driver will recover automatically.

No-load protection

The LED Driver works in burst working mode to limit output voltage which allows the application to be able to work safely when LED string opens due to a failure.

Under voltage protection

The LED Driver will switch off when input voltage is lower than 150-170VAC.

Storage condition

Humidity 5%-85%

Non-Condensable

*max. 60 days per year at 85 % humidity

Storage temperature: -30 °C up to max. +75 °C

The devices have to be within the specified temperature range (ta) before they can be operated.

Flicker Free Concealed Adaptor with Integrated LED Driver

Replace LED module

- Mains off
- Remove LED module
- Wait for 10 seconds
- Connect LED module again

Hot plug-in or secondary switching of LEDs is not permitted and may cause a very high impulse current to the LEDs.

Lamp isolation and electric strength test.

Electronic devices can be damaged by high voltage. This has to be considered during the routine testing of the luminaires in production..

According to IEC 60598-1 Annex Q or ENEC 303- Annex A, each lamp must be tested by 50VDC/1s isolation test.* The isolation resistance must be at least 100MΩ.

As an alternative, IEC 60598-1 Annex Q describes a 2000V electric strength test.

Installation instructions

Maximum loading: 50N (Inclusive of the weight of luminaires and accessories) / max torque: 2,5Nm

The LED module and all contact points within the wiring must be sufficiently insulated against 2 KV surge voltage. Air and creepage distance must be maintained.

Wiring guidelines

Wiring type and cross section

The wire can be stranded wire and output wire can be 0.5 – 1.5 mm².

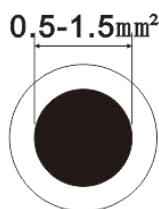

Photo a2

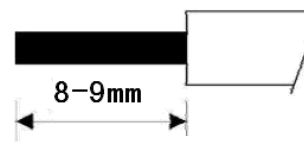

Photo 2

Strip 8-9 mm of insulation from the cable ends to ensure perfect operation of the wire terminals. Each terminal block only for one piece of wire.

Flicker Free Concealed Adaptor with Integrated LED Driver

| Item No. | Output current (230VAC Full load) | Input current (230VAC Full load) | Input load (230VAC Full load) | Output load range | PF (full load) | Efficiency (full Load) | Output voltage range |
|-------------------|--------------------------------------|-------------------------------------|----------------------------------|----------------------|-------------------|---------------------------|----------------------------|
| SC40W900-1050CG-4 | 900mA | 0.28A | 45.5W | 39.6W | 0.92 | 88% | 30-44V |
| | 950mA | 0.28A | 45.8W | 39.9W | 0.92 | 88% | 30-42V |
| | 1000mA | 0.28A | 45.9W | 40W | 0.95 | 88% | 30-40V |
| | 1050mA | 0.28A | 45.8W | 39.9W | 0.95 | 88% | 30-38V |

All parameters are tested at 220VAC input, full load and 25°C ambient temperature after connected to power for 30 minutes.

Expected life time

| Item No. | Output current | Ta | 35°C | 40°C |
|-------------------|-------------------|-----------|--------|--------|
| SC40W900-1050CG-4 | 900mA | tc | 67.6 | 76.9 |
| | | Life-time | 70000H | 50000H |
| | 950mA | tc | 68.1 | 77.8 |
| | | Life-time | 70000H | 50000H |
| | 1000mA | tc | 68.8 | 78.6 |
| | | Life-time | 70000H | 50000H |
| | 1050mA | tc | 69 | 78.9 |
| | | Life-time | 70000H | 50000H |

*The LED Drivers are designed for a life-time stated above under reference conditions and with a failure probability of less than 10 %.

Flicker Free Concealed Adaptor with Integrated LED Driver

Lamp screw type

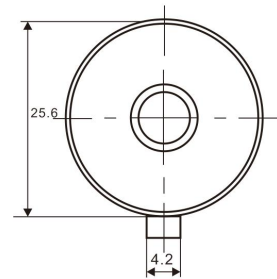
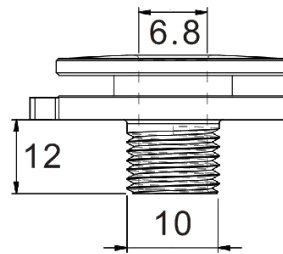
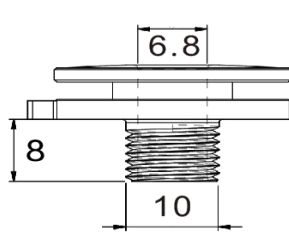

DIP Switch Operation instructions (*Hot-line working prohibited)

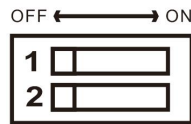

| PIN1 | PIN2 | I _{rated} [mA] | P _{rated} [W] |
|------|------|----------------------------|---------------------------|
| OFF | OFF | 900 | 39.6 |
| ON | OFF | 950 | 39.9 |
| OFF | ON | 1000 | 40 |
| ON | ON | 1050 | 39.9 |

DIP switch parameters:

contact resistance (initial value): $\leq 50\text{m}\Omega$
 contact resistance (after testing): $\leq 100\text{m}\Omega$
 switching capacity (switches frequently switched): 25mA 24VDC
 switching capacity (switches not switched frequently): 100mA
 insulation resistance: $\geq 100\text{M}\Omega$.Min.at 500VDC
 dielectric strength: 500VAC Min. for 60 seconds.1mA
 interelectrode capacitance: $\leq 5\text{PF}$
 operating force: 1000gf max
 electrical life: 3000 times

Flicker Free Concealed Adaptor with Integrated LED Driver

Wiring guidelines

- All connections must be kept as short as possible to ensure good EMI behaviour.
- Mains leads should be kept apart from LED Driver and other leads (ideally 5 – 10 cm distance)
- Secondary switching is not permitted.
- Incorrect wiring can damage LED modules.
- The wiring must be protected against short circuits to earth.

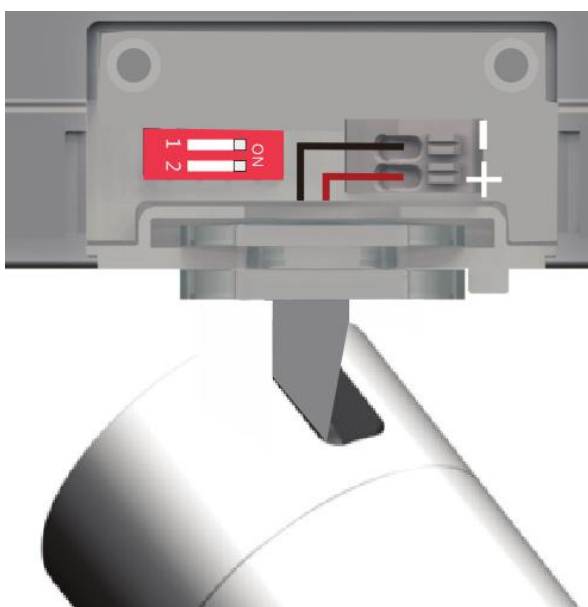

SC40W900-1050CG-4 (900mA)

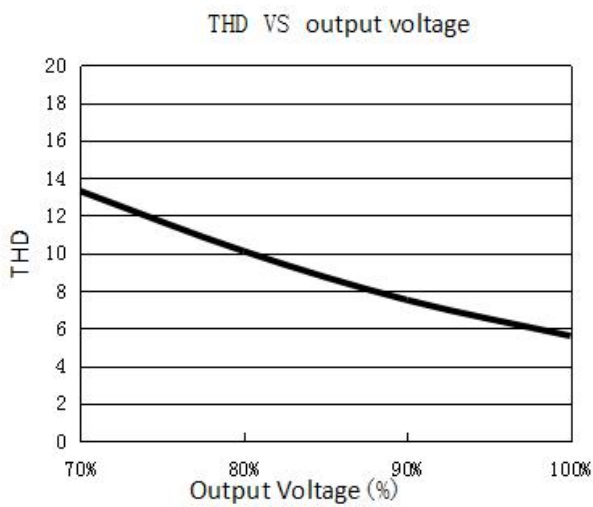
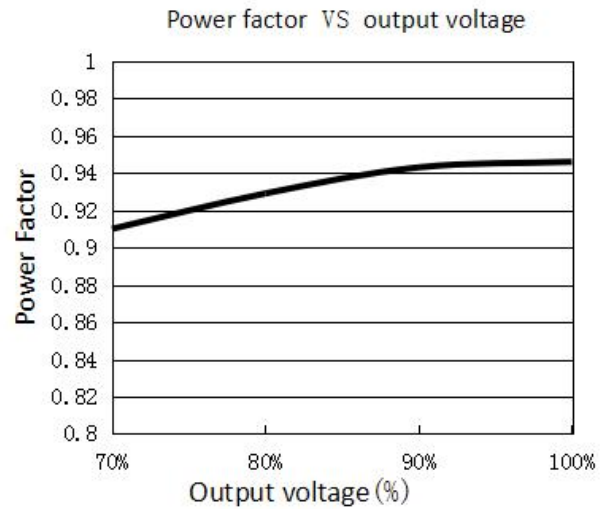
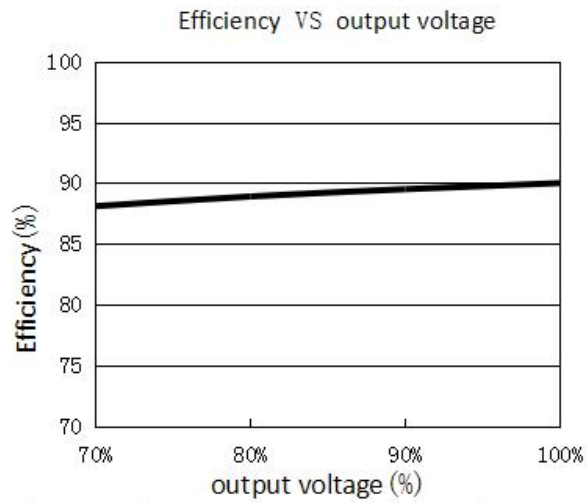

SC40W900-1050CG-4 (950mA)

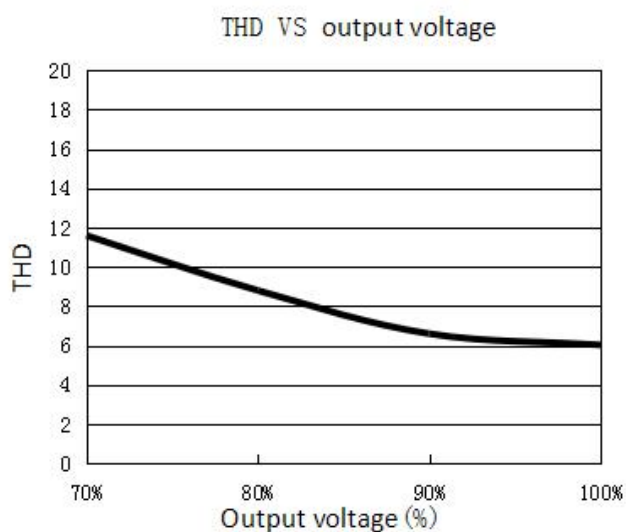
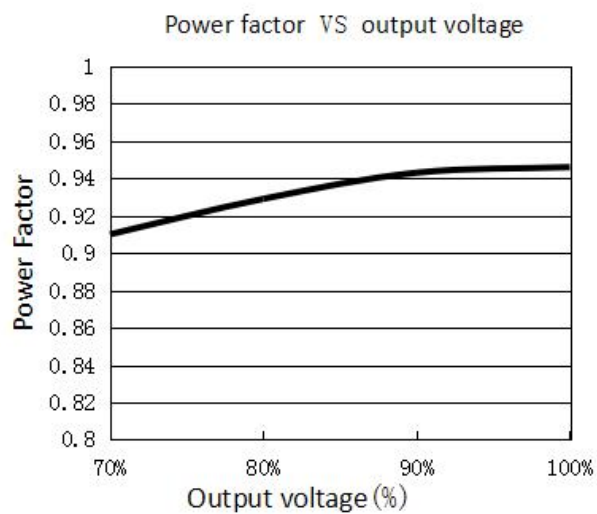
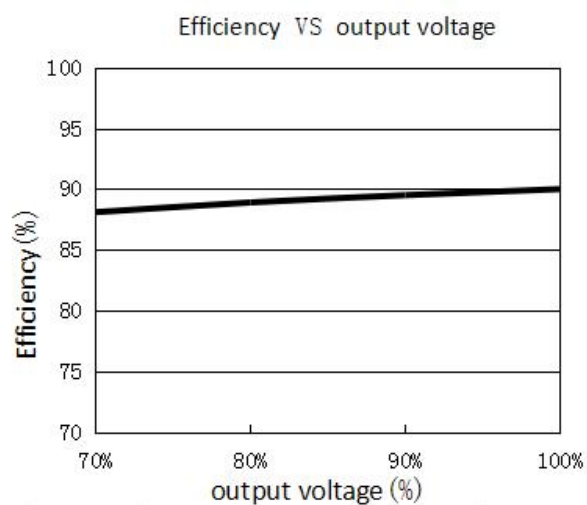

SC40W900-1050CG-4 (1000mA)

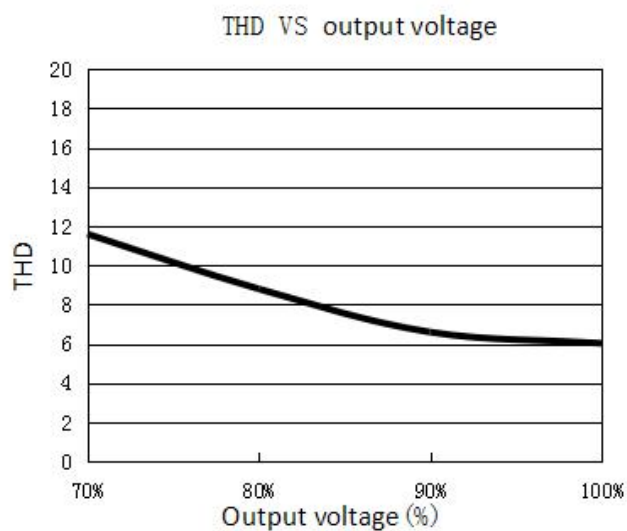
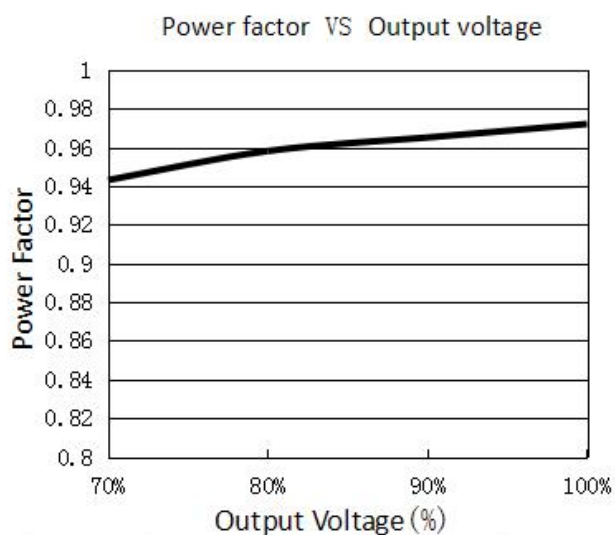
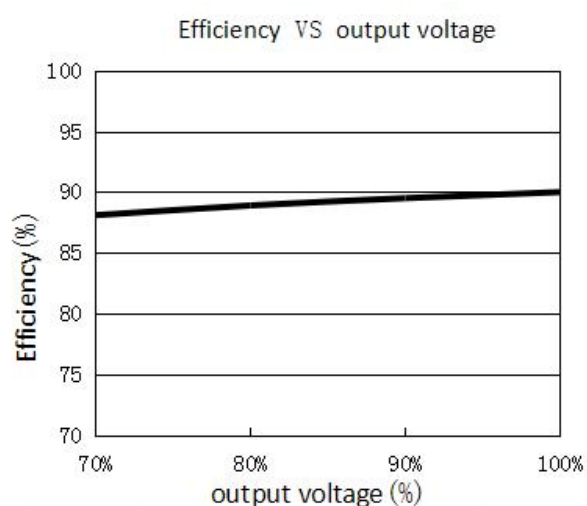

SC40W900-1050CG-4 (1050mA)

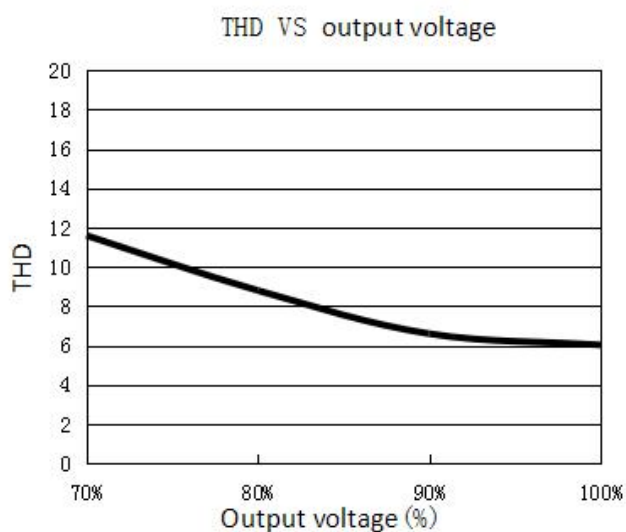
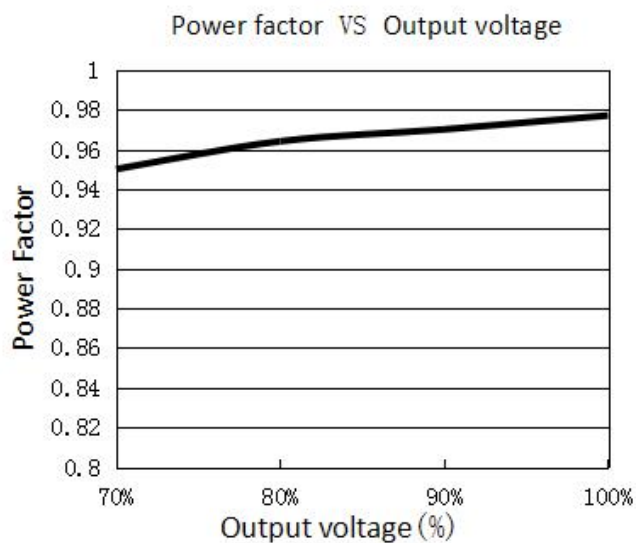
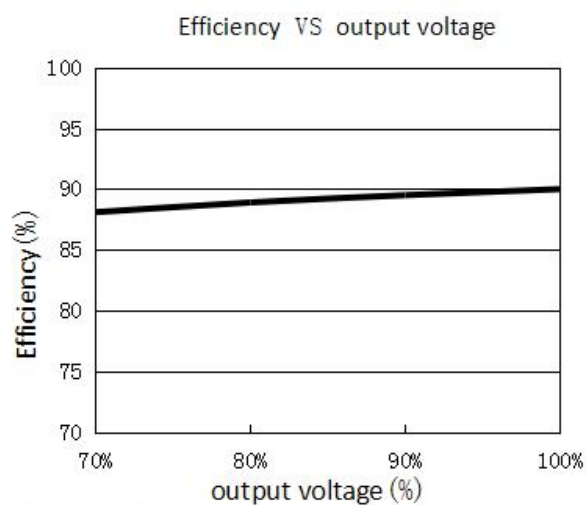

Flicker Free Concealed Adaptor with Integrated LED Driver

Packing information:

| Item No | Carton L*W*H(mm) | Pcs/Carton | Net weight/ Pcs(kg) | Net weight/ Carton(kg) | Gross weight / Carton(kg) |
|-------------------|---------------------|------------|------------------------|---------------------------|------------------------------|
| SC40W900-1050CG-4 | 515*274*370 | 90 | 0.145 | 13.05 | 14.5 |

3 Phase track light rail specification (for reference only):

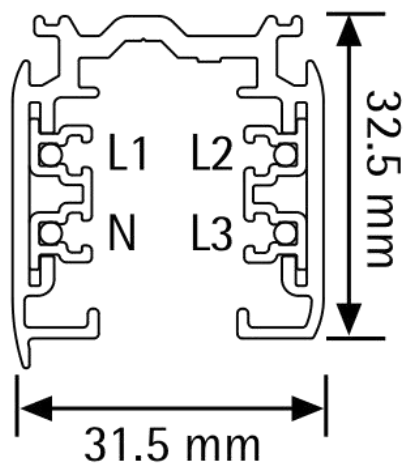
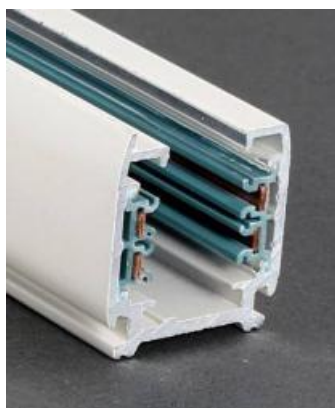

Lighting track adapter and rail system installation diagram (for reference only):



The adaptor shall be given that the use is limited to the track system specified.