

Constant Current & Dimmable Driver

Model: SC15W200-350CG-4 Triac
SC22W400-550CG-4 Triac
SC32W650-800CG-4 Triac
SC40W850-1000CG-4 Triac



Model	Output Current	Input Current	Input Power	Output Power Range	PF	Efficiency	Output Voltage	No load Voltage
SC15W200-350CG-4 Triac	200mA	≤0.08A	≤12W	5.4-8W	≥0.92	≥80%	27-40V	≤55V
	250mA	≤0.08A	≤14W	6.75-10W				
	300mA	≤0.1A	≤15W	8.1-12W				
	350mA	≤0.1A	≤20W	9.45-14W		≥82%		
SC22W400-550CG-4 Triac	400mA	≤0.13A	≤21W	10.8-16W	≥0.92	≥83%	27-40V	≤55V
	450mA	≤0.13A	≤25W	12.1-18W		≥84%		
	500mA	≤0.15A	≤25W	13.5-20W		≥84%		
	550mA	≤0.16A	≤27W	14.8-22W		≥84%		
SC32W650-800CG-4 Triac	650mA	≤0.16A	≤32W	17.55-26W	≥0.92	≥85%	27-40V	≤55V
	700mA	≤0.18A	≤32W	18.9-28W				
	750mA	≤0.2A	≤36W	20.25-30W				
SC40W850-1000CG-4 Triac	850mA	≤0.22A	≤45W	22.9-34W	≥0.92	≥85%	27-40V	≤55V
	900mA	≤0.24A	≤45W	24.3-36W				
	950mA	≤0.26A	≤48W	25.6-38W				
	1000mA	≤0.28A	≤48W	27-40W				

* Test result @230V, 50Hz, Full Load.

1. Parameters

Category	Item	Technical Norm
Features	Output Type	Constant Current
	Dimming Type	Phase dimming
	Dimming Range	10%-100%
	IP Grade	IP20
	Insulation Class	Class II
Input	Rated Input Voltage	220-240VAC_stable
	Range of Input Voltage	198-264VAC_stable or 180-280VDC_stable
	Frequency	50/60Hz
	Input Current	≤0.28A

	Input Power	≤48W
	Power Factor	≥0.92 (230VAC,full load)
	THD	≤20% (230VAC,full load)
	No-load Power Consumption	≤0.5W @230VAC
Output	Output Voltage	27-40V
	Output Current:	
	SC15W200-350CG-4 Triac	200/250/300/350
	SC22W400-550CG-4 Triac	400/450/500/550
	SC32W650-800CG-4 Triac	650/700/750/800
	SC40W850-1000CG-4 Triac	850/900/950/1000
	No Load Voltage	55VDC Max
	Max. Output Power:	
	SC15W200-350CG-4 Triac	14W
	SC22W400-550CG-4 Triac	22W
	SC32W650-800CG-4 Triac	32W
SC40W850-1000CG-4 Triac	40W	
Efficiency	≥85%	
Current Ripple(< 120 Hz)	±5% (Imax-Imin)/(Imax+Imin)	
PstLM	≤1	
SVM	≤0.4	
Current Accuracy	±5%	
Started Delay Time	≤0.5S (230VAC,full load)	
Protection	Short Circuit Protection	Auto Recovery
	Overload Protection	Auto Recovery
	No-load Protection	Auto Recovery
	Insulation voltage	I/P to O/P , 3.75KVac/1min
	Ta/Operation Temperature	-20....+35℃
Environment	Ts/Storage Temperature	-40....+85℃
	Tc/Enclosure Temperature	85℃ @15W AND 22W 80℃ @32W AND 40W
	Humidity	10%....90%RH
	Atmosphere	86-108KPa
	Connection Method	Push-in Terminal
Construction	Installation	Independent
	PRI Wire preparation	0.75-1.5 ^φ
	SEC Wire preparation	0.5-1.5 ^φ
	Dimension	195.4*31*41.9mm (L*W*H)@15W/22W 249.9*31*42mm(L*W*H)@32W/40W
	Certification	complied to CE SAA @32W AND 40W complied to CE ENEC SAA @15W AND 22W
Standards	Safety Standards	EN61347-1:2015,EN61347-2-13:2014/A1:2017 , EN62384:2006/A1:2009,EN61347-1:2015/A1:2021, AS61347.2.13:2018,AS/NZS61347.1:2016 Inc A1

	EMC Standards	EN IEC 55015:2019,EN IEC 55015:2019/A11:2019, EN IEC 61000-3-2:2019,EN 61000-3-3:2013/A1:2019, EN61547:2009, EN IEC 55015:2019/A11:2020
	Performance	EN62384
	Surge	L-N/2KV
	RoHS	complied to 2011/65/EU
Others	Life Time	50000h @35°C (Ta) / (Tc)
	Warranty	5years , F.R. < 10000ppm
	Noise	15cm <28dB

Remark: 1. Specific instructions are not all parameters are not connect dimmer input voltage 230 vac / 50 Hz and 25 °C ambient temperature measured.

2. LED Driver is a component of the luminaires, Luminaires and wire layout will affect the EMC, please check the EMC with end products again.

3. Only trailing edge dimmable.

2. Trailing Edge Dimmer list approved by KGP

Manufacturer	Model	Q'ty of parallel connection
ABB	6519 U	11
ABB	6526 U	10
JUNG	1224 LED UDE	11
Berker	2861	10
JUNG	254 UDIE 1	10
JUNG	225 TDE	12
EGANT	U321V2	10
Schneider	SBD200LED	10
Schneider	SBD315RC	11
Merten	SBD200LED	10
Berker	2874	12
Eetako	EUD61NPL-230V	12

Leading Edge Dimmer list only on request -/ or confirmed by KGP Electronics

3. Connected quantities of different current Breaker
15W:

TYPE	Connected quantities of different current Breaker						Input Voltage	Inrush Current	Time
	current (A)	10	13	16	20	25			
	Installation wire diameter	1.5mm ²	2.5mm ²	2.5mm ²	4mm ²	4mm ²			
TYPE B	60	78	96	120	150	@230VAC	10	13.5μs	
TYPE C	96	125	154	192	240				
TYPE D	154	200	246	307	384				

22W:

TYPE	Connected quantities of different current Breaker						Input Voltage	Inrush Current	Time
	current (A)	10	13	16	20	25			
	Installation wire diameter	1.5mm ²	2.5mm ²	2.5mm ²	4mm ²	4mm ²			
TYPE B	30	39	48	60	75	@230VAC	20	400μs	
TYPE C	48	62	77	96	120				
TYPE D	77	100	123	154	192				

32W:

TYPE	Connected quantities of different current Breaker						Input Voltage	Inrush Current	Time
	current (A)	10	13	16	20	25			
	Installation wire diameter	1.5mm ²	2.5mm ²	2.5mm ²	4mm ²	4mm ²			
TYPE B	15	20	24	30	38	@230VAC	40	500μs	
TYPE C	24	31	38	48	60				
TYPE D	38	50	61	77	96				

40W:

TYPE	Connected quantities of different current Breaker						Input Voltage	Inrush Current	Time
	current (A)	10	13	16	20	25			
	Installation wire diameter	1.5mm ²	2.5mm ²	2.5mm ²	4mm ²	4mm ²			
TYPE B	13	17	21	27	33	@230VAC	45	500μs	
TYPE C	21	28	34	43	53				
TYPE D	34	44	55	68	85				

4. Label

KGP
KGP Electronics GmbH
Hueckstraße 19
DE-58511 Lüdenscheid
LED Dimmable Driver
SC15W200-350CG-4 Triac
Constant Current Lighting track adaptors

No load:55VDC Max.
Fmax.50N+

tc=85°C

PIN1	PIN2	I _{rated} [mA]	P _{rated} [W]	U _{rated} [V]	U _N /f _N	I _N [A]	t _a [°C]	λ
OFF	OFF	200	8	27-40	220-240V 50/60Hz	0.08	-20...+35	0.90C
OFF	ON	250	10					0.92C
ON	OFF	300	12					0.92C
ON	ON	350	14					0.92C

SELV

For LED modules only

KGP
KGP Electronics GmbH
Hueckstraße 19
DE-58511 Lüdenscheid
LED Dimmable Driver
SC22W400-550CG-4 Triac
Constant Current Lighting track adaptors

No load:55VDC Max.
Fmax.50N+

tc=85°C

PIN1	PIN2	I _{rated} [mA]	P _{rated} [W]	U _{rated} [V]	U _N /f _N	I _N [A]	t _a [°C]	λ
OFF	OFF	400	16	27-40	220-240V 50/60Hz	0.13	-20...+35	0.92C
OFF	ON	450	18					0.92C
ON	OFF	500	20					0.92C
ON	ON	550	22					0.92C

SELV

For LED modules only

KGP
KGP Electronics GmbH
Hueckstraße 19
DE-58511 Lüdenscheid
LED Dimmable Driver
SC32W650-800CG-4 Triac
Constant Current Lighting track adaptors
For LED modules only

No load:55VDC Max.
Fmax.50N+

tc=80°C

PIN1	PIN2	I _{rated} [mA]	P _{rated} [W]	U _{rated} [V]	U _N /f _N	I _N [A]	t _a [°C]	λ
OFF	OFF	650	26	27-40	220-240V 50/60Hz	0.16	-20...+35	0.92C
ON	OFF	700	28					0.92C
OFF	ON	750	30					0.92C
ON	ON	800	32					0.92C

SELV

For LED modules only

KGP
KGP Electronics GmbH
Hueckstraße 19
DE-58511 Lüdenscheid
LED Dimmable Driver
SC40W850-1000CG-4 Triac
Constant Current Lighting track adaptors
For LED modules only

No load:55VDC Max.
Fmax.50N+

tc=80°C

PIN1	PIN2	I _{rated} [mA]	P _{rated} [W]	U _{rated} [V]	U _N /f _N	I _N [A]	t _a [°C]	λ
OFF	OFF	850	34	27-40	220-240V 50/60Hz	0.22	-20...+35	0.92C
ON	OFF	900	36					0.92C
OFF	ON	950	38					0.92C
ON	ON	1000	40					0.92C

SELV

For LED modules only

5. Dimming curve

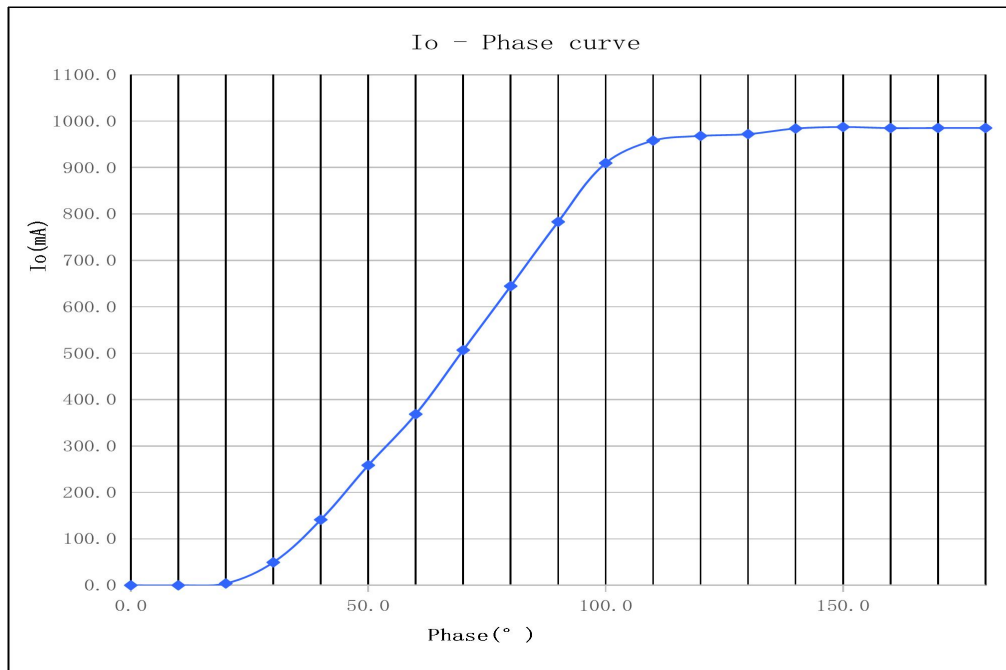

6. Lifetime curve

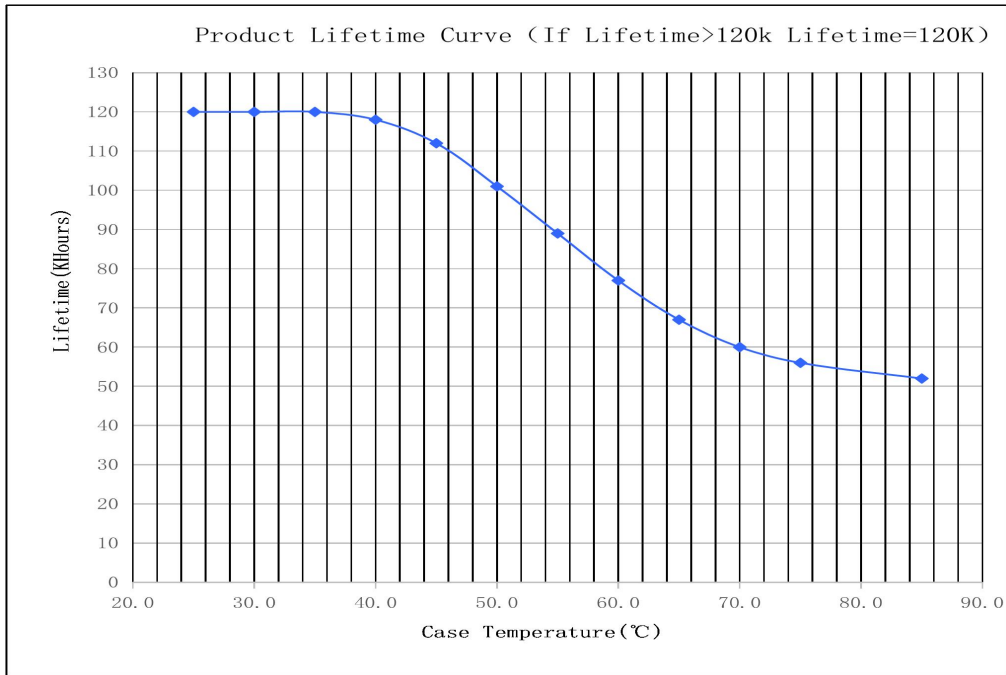

7. Dimension (Unit: mm)

15W/22W:

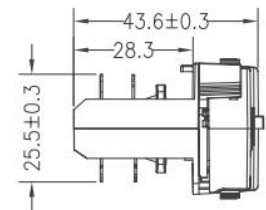
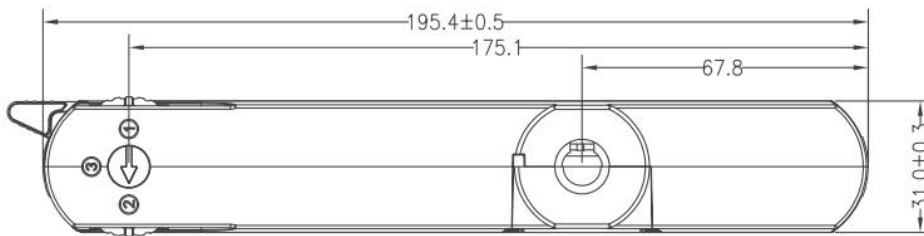
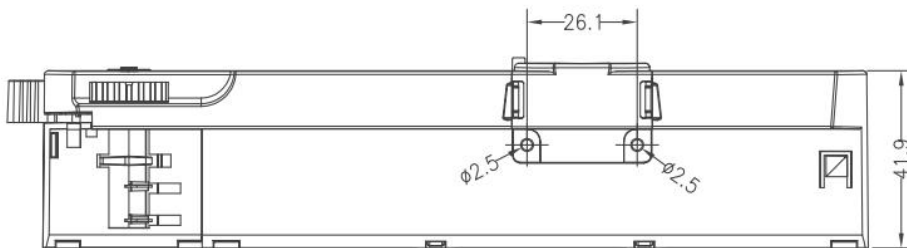

32W/40W:

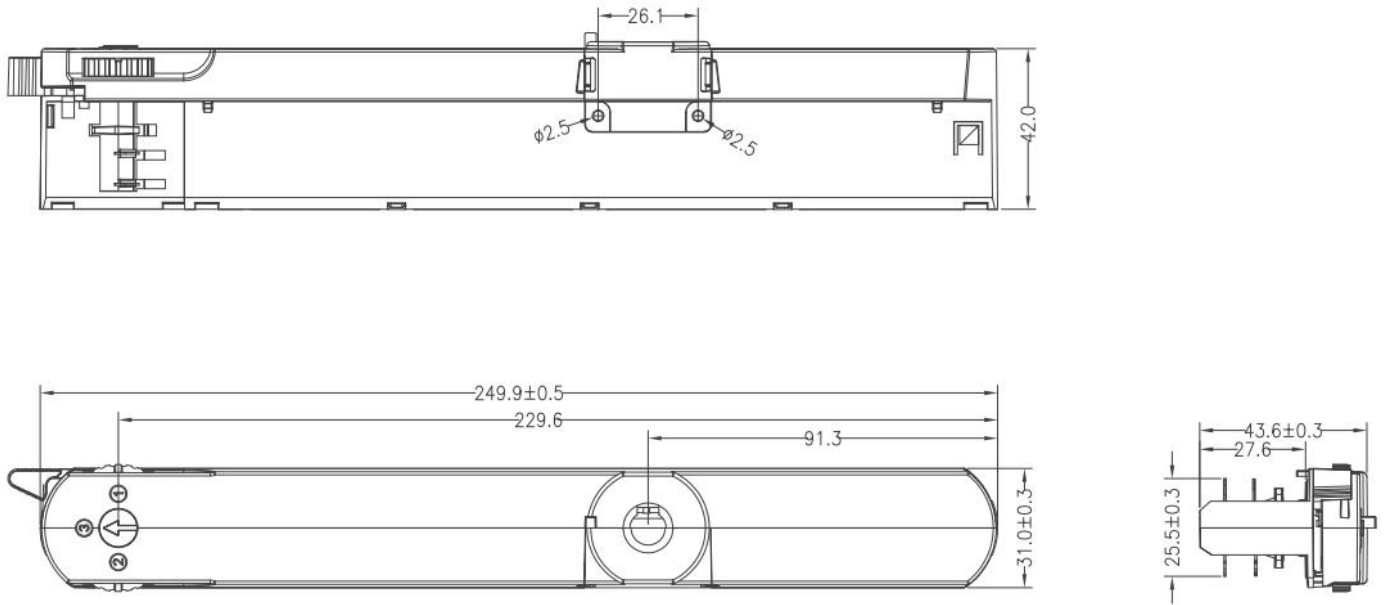

8. Wiring Diagram

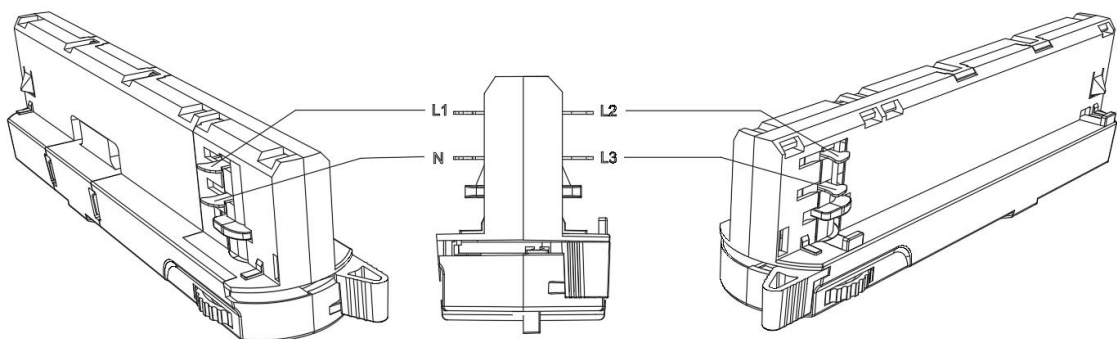
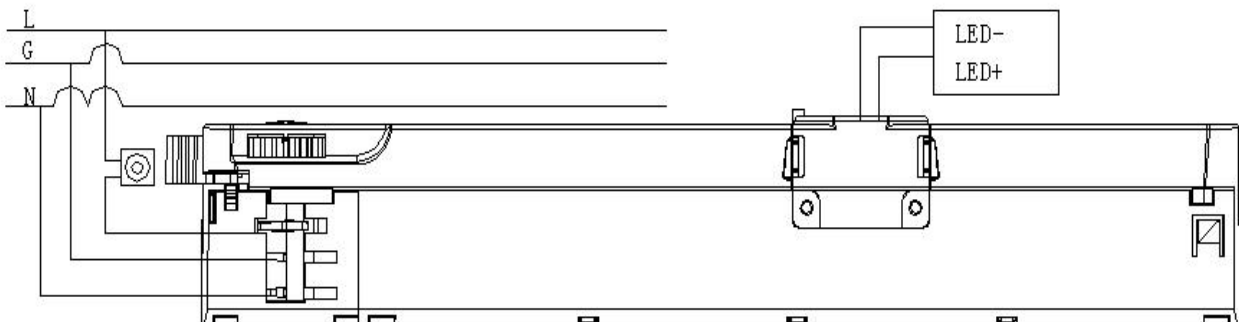

9. Packing information

Model	Carton Size(mm)	Pcs/ Carton	Net weight/ Pcs(kg)	Net weight/ Carton(kg)	Gross weight / Carton(kg)
SC15W200-350CG-4 Triac	515*274*370	100	0.12	12	14.6
SC22W400-550CG-4 Triac	515*274*370	100	0.12	12	14.6
SC32W650-800CG-4 Triac	515*274*370	90	0.145	13.05	14.5
SC40W850-1000CG-4 Triac	515*274*370	90	0.145	13.05	14.5

10.Lamp Screw Type

1. Optional threaded sleeve for luminaire mounting
2. Suitable for M10x1x8 threaded nut
3. Additional mounting equipment,e.g.M10x1x12
4. aluminium, black, white, grey
5. further on request

Ordering data

Type	Colour	Qty/ctn	Weight/pcs
M10x1x8	White	2500	9.31
	Black	2500	9.31
	Gray	2500	9.31
M10x1x12	White	2500	10.01
	Black	2500	10.01
	Gray	2500	10.01

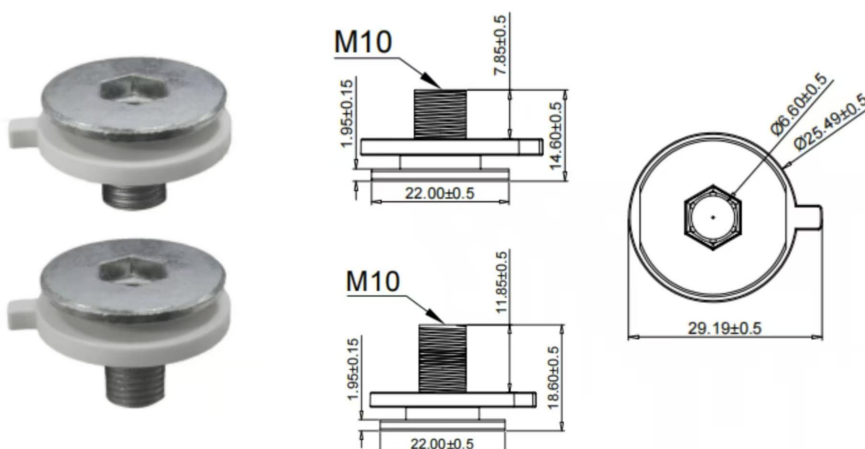

11.Suitable for following tracks

Serial number	Brand	Track model	System
1	Global	XTS11 & XTSC611	3P
2	A.A.G STUCCHI	9000A-2-ST	3P
3	Eutrac	25-106	3P
4	Unipro	T32B	3P
5	PowerGEAR	Pro-0431L	3P
6	ERCO	1079301000	3P

Remark:

1. The model name is XTS11 and XTSC611 tracks, and its brand is Global.
2. The model name used is the 9000A-2-ST track, and its brand is A.A.G STUCCHI.
3. The model name is 25-106 tracks, and its brand is Eutrac.
4. The model name is T32B tracks, and its brand is Unipro.
5. The model name is Pro-0431L tracks, and its brand is PowerGEAR.
6. The model name is 1079301000 tracks, and its brand is ERCO.
7. If other brands are suitable, please communicate and consult first

12.Wiring instructions

- All connections must be kept as short as possible to ensure good EMI behaviour
- Mains leads should be kept apart from LED Driver and other leads (ideally 5 – 10 cm distance)
- Advice the maximum length of output wires is 3 m
- Secondary switching is not permitted (Except for constant voltage)
- Incorrect wiring can damage LED modules.
- The wiring must be protected against short circuits to earth (sharp edged metals parts, metal cable clips, louver, etc.)

13.REVISION HISTORY

DATE	REV.	REMARK
2022-10-19	V1.0	Initial release.
2023-8-31	V1.1	Update icon
2023-12-8	V1.2	Update dimensional drawing
2024-9-3	V1.3	Update nipple and compatible track
2024-12-31	V1.4	Update nipple